

NÁVOD / INSTRUCTION

Roll Up Standard

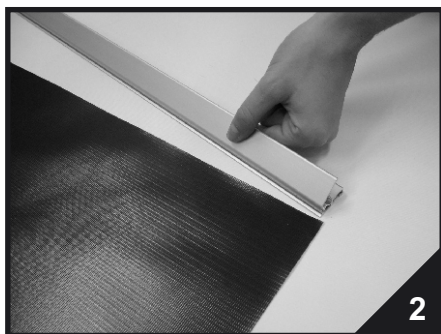

1. Package content.



2. Insert upper part of theme into the clipframe.

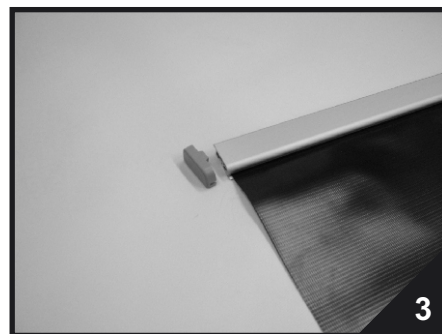

3. Attach head plates.

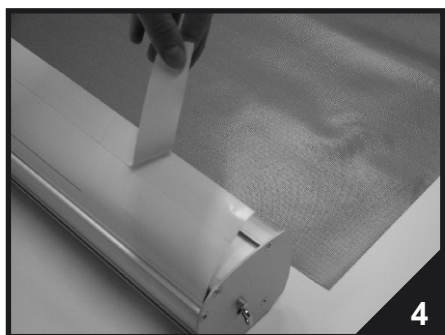

4. Remove the covering tape from the base unit.



5. We recommend to put on super glue along the whole width of the tape – that will prevent unwanted pull-up of the theme from the base unit.



6. Affix the theme.



7. Hold the theme and carefully pull out the securing buckle from the side. Theme will roll into the base unit.

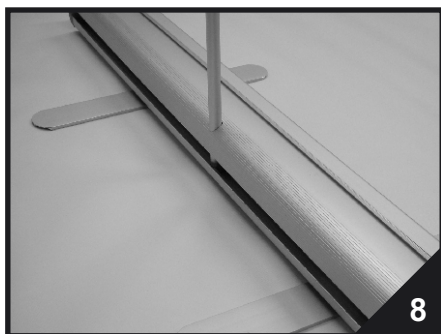

8. Insert supporting pole into the back part and tip out legs from the base unit.



9. Pull out the theme from the base unit and support it in the back with the pole.

If you don't follow instructions in this manual, we will not acknowledge any potential complaints.